

SPECIFICATION SHEET

Liberty 900mm 1 Drawer Washstand



Features

- Floorstanding
- 1 Drawer
- Single Basin
- Colours: Timber Veneer on Plywood
- Dimensions: H850 x W900 x D465

Colour Options with Code

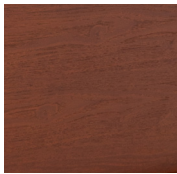

Belmar Maple
8957BM



Hampton Beech
8957HB

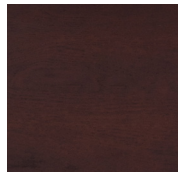

Saddle Rock
8957SR

Technical Details

Note: All measurements shown are in millimetres. Sizes are nominal.

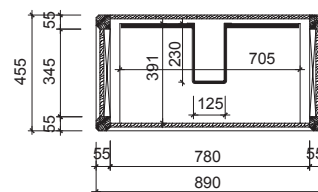
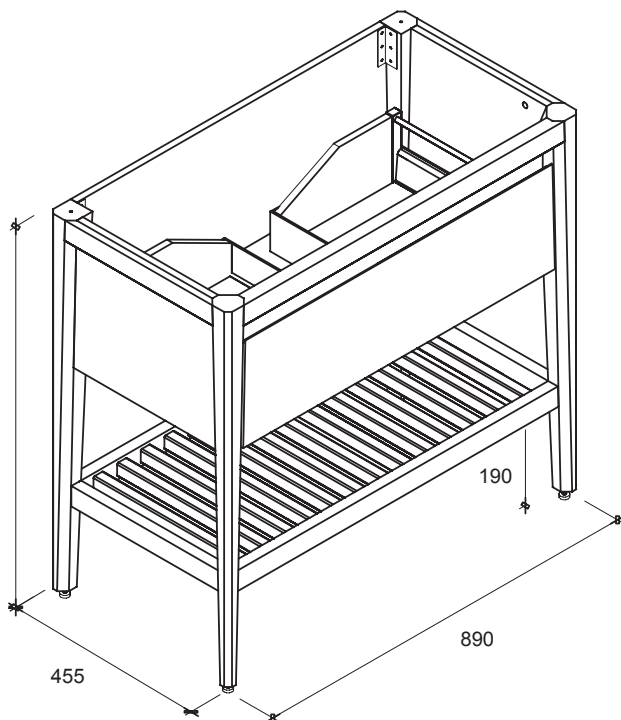

TOP VIEW

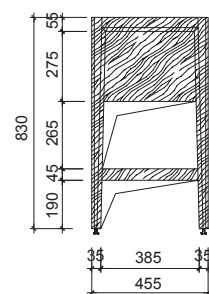
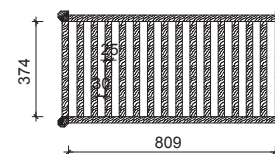

SIDE VIEW

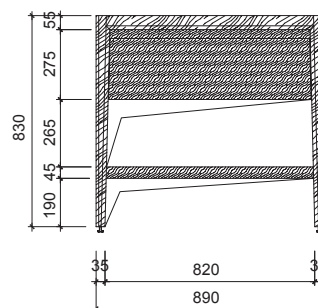

FRONT VIEW

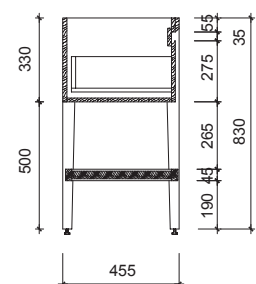

SPECIFICATION SHEET

900mm Basin Options

Delgado

Stonecast with Overflow
DG900

W900 x D460 x H15

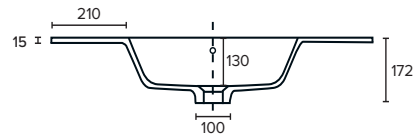
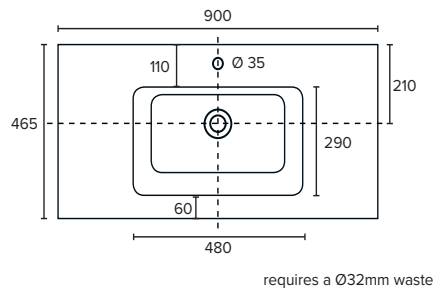
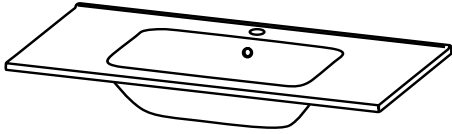

Clasico

Vitreous China with Overflow
4225

W910 x D465 x H20

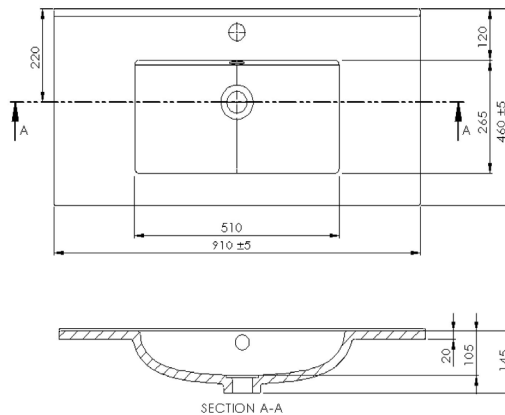
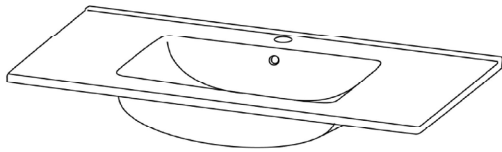

Rosa

Stonecast with Overflow
VR900

W900 x D465 x H25

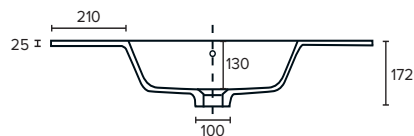
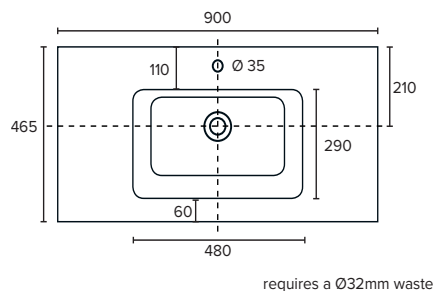
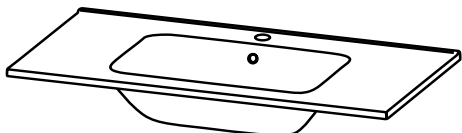

SPECIFICATION SHEET

900mm Basin Options

Ari

Stonecast with Overflow
VA900

W900 x D465 x H50

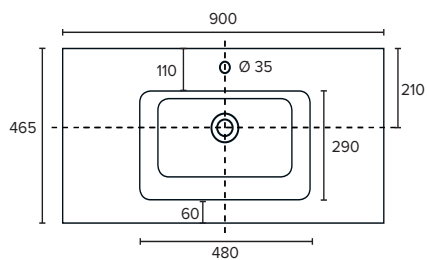
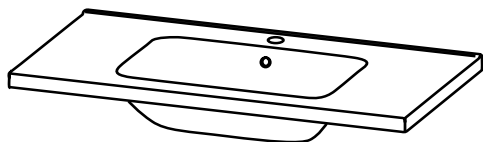

requires a Ø32mm waste

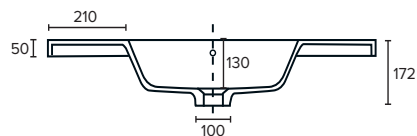

SPECIFICATION SHEET

Vessel Basin Options

Slab Top

StoneCast 35mm / Solid Timber Top 20mm
ST

Available in sizes 750, 900,
1200, 1500, 1800

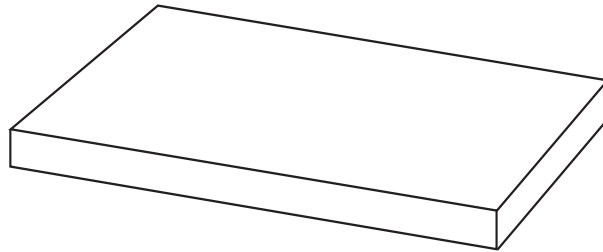

EOS Rectangular

Vitreous China with Overflow
34020

W395 x L595 x H115

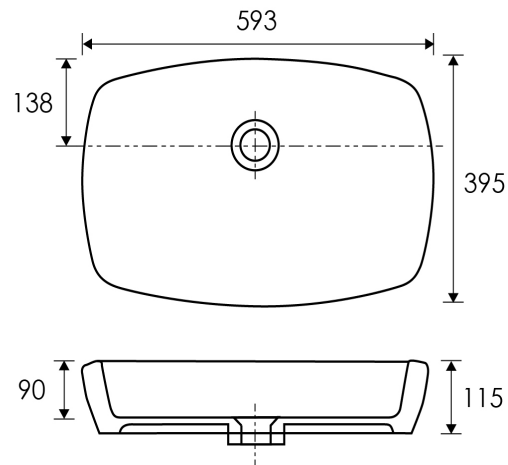
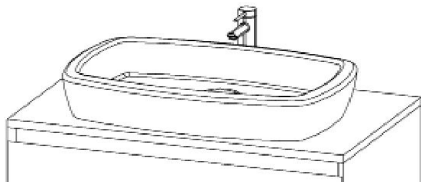

EOS Oval

Vitreous China with Overflow
34030

W395 x L595 x H115

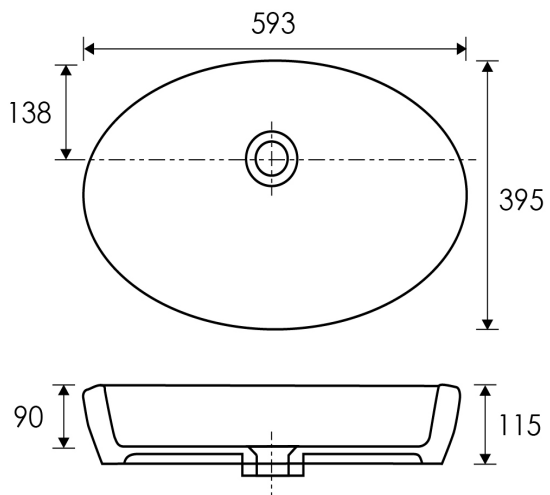
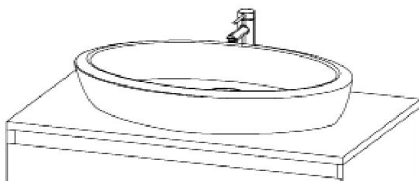

SPECIFICATION SHEET

Vessel Basin Options

EOS Round

Vitreous China with Overflow
34050

W395 x H115

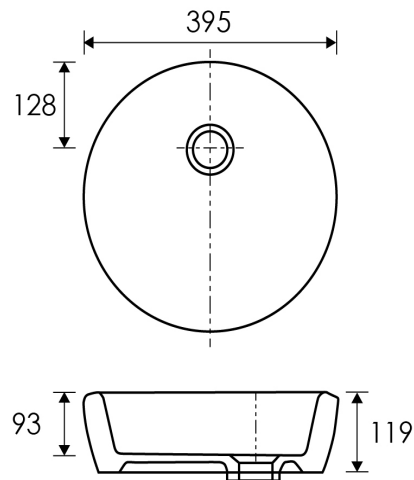
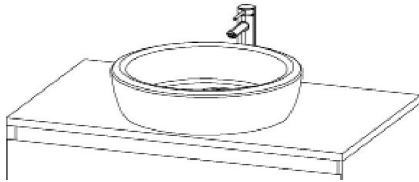

EOS Square

Vitreous China with Overflow
34040

W395 x L395 x H115

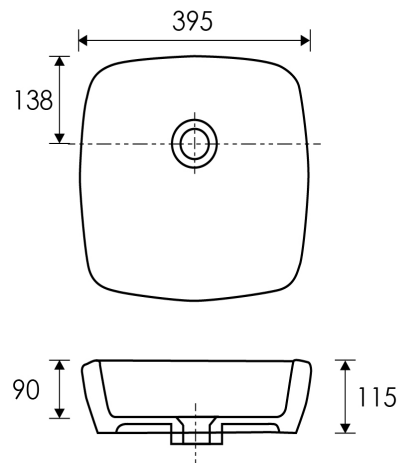
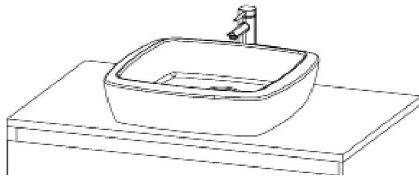

Quarto Rectangular

Vitreous China with Overflow
7330

W340 x L550 x H85

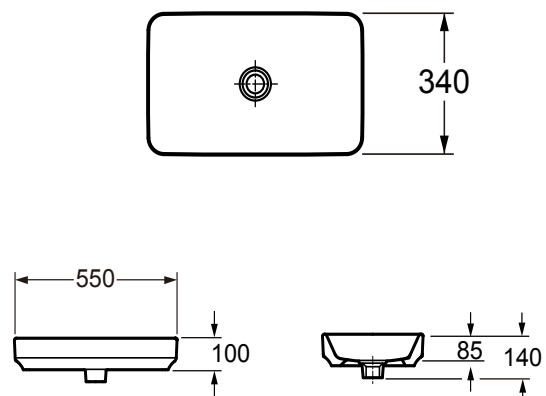
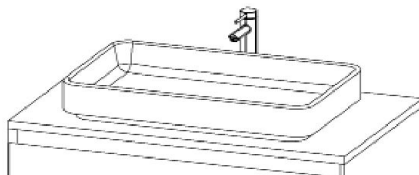

SPECIFICATION SHEET

Vessel Basin Options

Quarto Oval

Vitreous China with Overflow
7340

W350 x L550 x H100

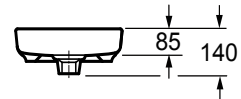
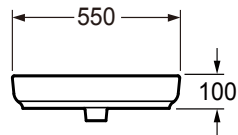
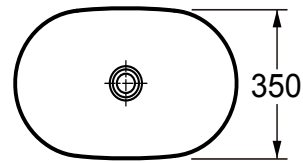
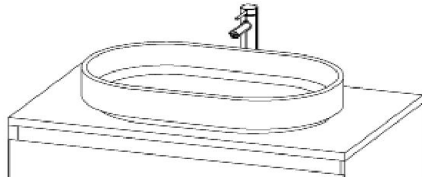

Quarto Round

Vitreous China with Overflow
7350

W400 x H120

