

# SPECIFICATION SHEET

## Vessel Basin Options

---

### Slab Top

StoneCast Top 35mm / Solid Timber Top 20mm / Quartz Top 20mm

Available in sizes 750, 900,  
1200, 1500, 1800

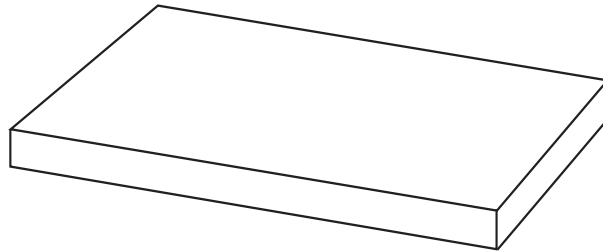

### EOS Rectangular

Vitreous China  
34020

W395 x L595 x H115

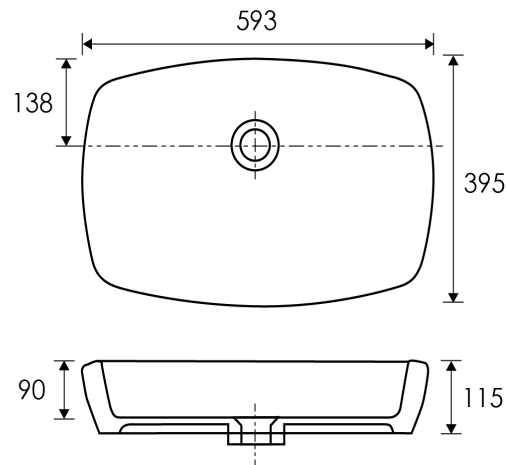
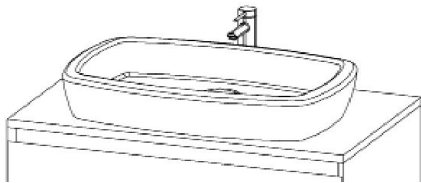

### EOS Oval

Vitreous China  
34030

W395 x L595 x H115

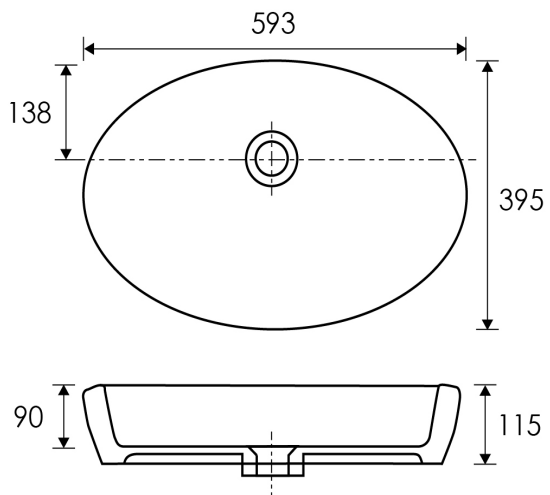
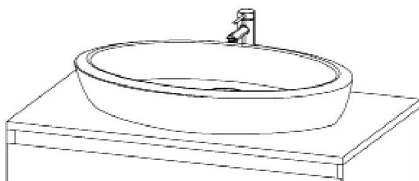

# SPECIFICATION SHEET

## Vessel Basin Options

---

### EOS Round

Vitreous China  
34050

W395 x H115

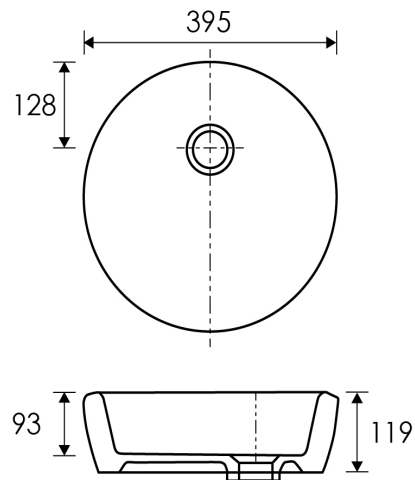
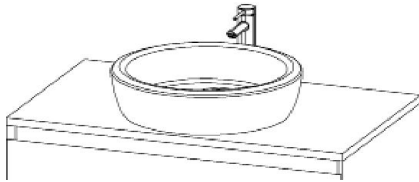

### EOS Square

Vitreous China  
34040

W395 x L395 x H115

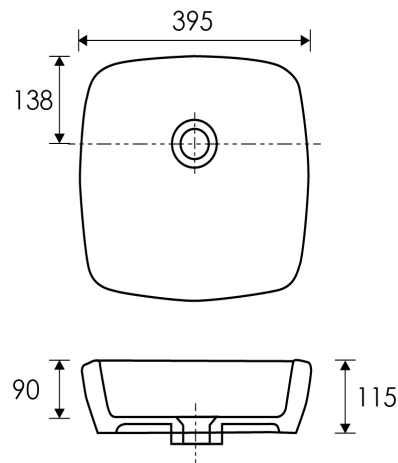
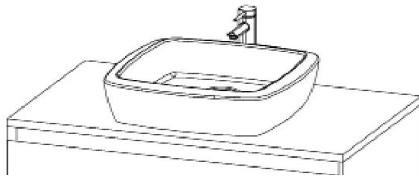

### Quarto Rectangular

Vitreous China  
7330

W340 x L550 x H85

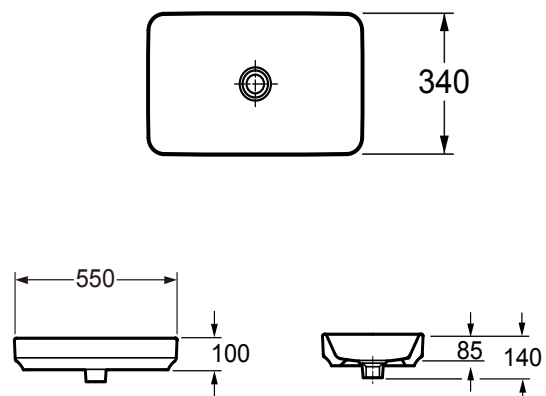
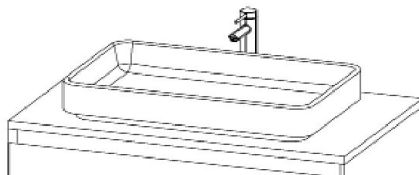

# SPECIFICATION SHEET

## Vessel Basin Options

### Quarto Oval

Vitreous China  
7340

W350 x L550 x H100

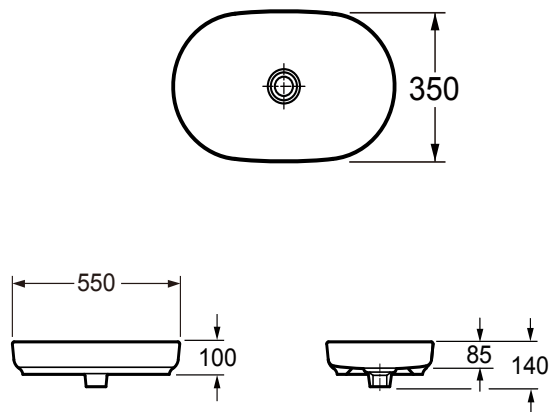
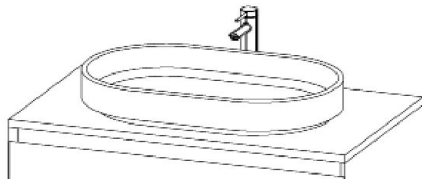

### Quarto Round

Vitreous China  
7350

W400 x H120

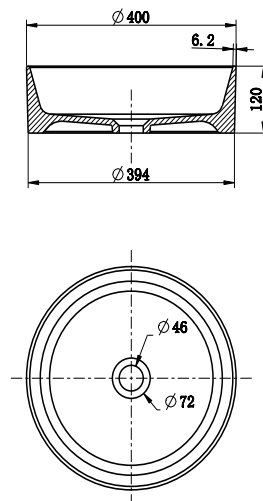
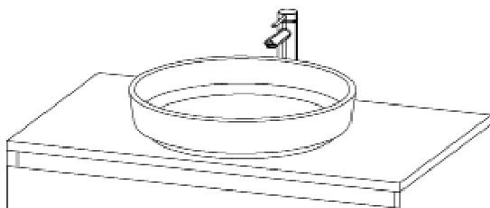

### Ravani Semi-Recessed Rectangular Basin

Vitreous China  
7326

W380 x L500 x H80

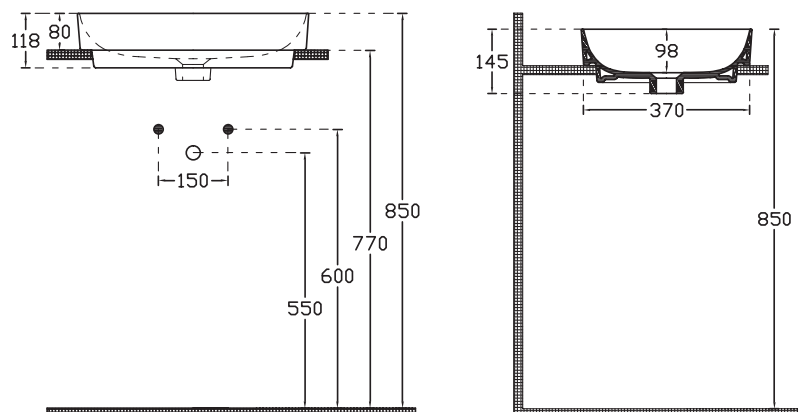
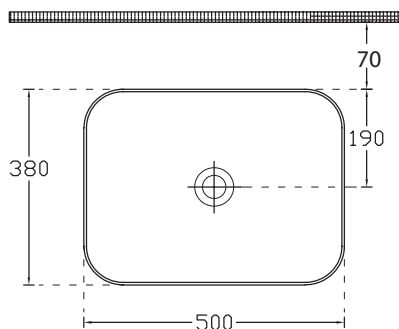

# SPECIFICATION SHEET

## Vessel Basin Options

### Coral Ridge Round

Vitreous China

7351 (White) 7352 (Black)

H135 X W385

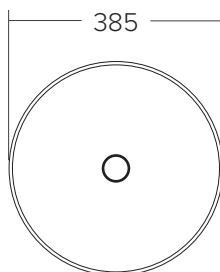
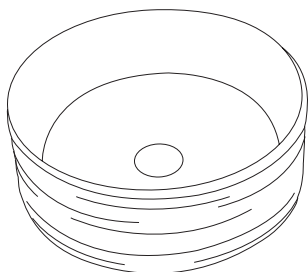

### Coral Ridge Square

Vitreous China

7353 (White) 7354 (Black)

L380 X W380 X H135

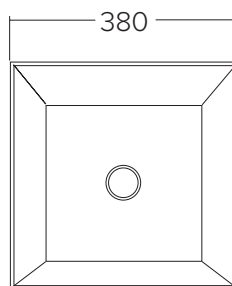
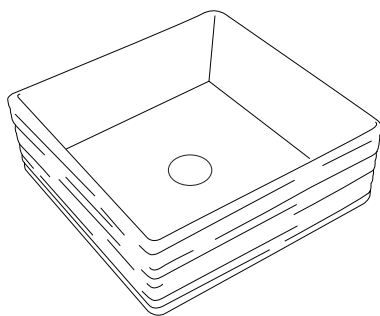

### Coral Diamond Round

Vitreous China

7356 (White)

H120 X W355

